

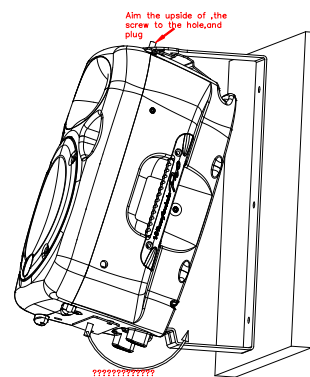

② The second step

## ② The second step

To installation the top plate and bottom plate,which attached to the loudspeaker,by M6 HEX HD Blot



### ③ The Third step

The Bolt on top plate in to the corresponding hole of wall bracket, then slope the loudspeaker, Move the screw on bottom plate, circling the exerted part of wall bracket. Push the loudspeaker from the side and aim the muddle of notch, and then pull it to the appropriate position. Finally mount gasket an nut, and in installation the lockup.

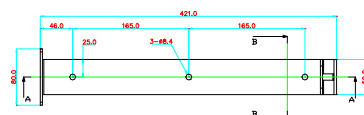
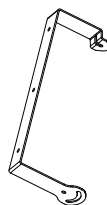
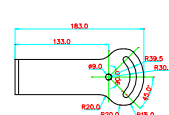
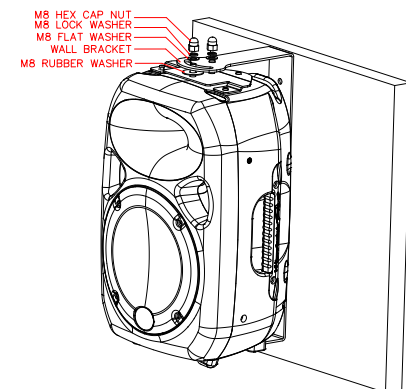

SECTION A-A

